



Installation Instructions

Precision Sport Shifter

2008 and up C6, C6(Z06), & C7

Chevrolet Corvette

(see www.bmracing.com for the latest vehicle fitment applications and model years)
Part Number 45034

©2014, 2012, 2010 by B&M Racing and Performance Products

This **B&M Precision Sport Shifter** has been designed to work on most 2008 and up C6, C6(Zo6), & C7 Corvette model vehicles. It has been engineered to greatly reduce shift throw and improve shifter feel. Check the parts and tools lists at the beginning of these instructions for the supplied parts and the tools required to install your **B&M Precision Sport Shifter**. Installation of this **B&M Precision Sport Shifter** can be accomplished by anyone with minimal mechanical experience.

INTRODUCTION

This **B&M Precision Sport Shifter** can be installed in less than an hour and a half by carefully following the instructions. Read all instructions first to familiarize yourself with the parts, tools, and procedures. This kit contains all the parts necessary to install the shifter.

PARTS



B&M Shifter



Spacer (2)



M5x0.8 Bolt (1)
M6x1.0 Bolt (1)



Gasket



Washer (4)



1/4"-20 Bolt (4)
& Washer (4)



Loctite®
242

TOOLS



7mm, 10mm,
7/16", 3/8"
Socket



Ratchet



Channel Locks



Extension



T-15, T-20,
T-25, T-40
Torx Socket



Trim Panel
Removal Tool



Small Flathead & Phillip
Screwdriver

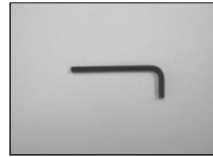

Allen Wrench
(3mm, 4mm)

DISASSEMBLY

STEP 1. Remove bolts securing arm rest and remove arm rest.

TOOLS: Ratchet, Extension, T-15 Torx Socket

For C7 application, skip **steps 2-4** and move on to **step 5**.



STEP 2. Remove covers of center console trim plate with small flathead screwdriver and remove (2) screws on center console.

Note: Some model years may require the use of a 7mm socket instead of T-15 torx to remove screws.

TOOLS: Ratchet, Extension, T-15 Torx or 7mm Socket



STEP 3. Pull up on sleeve around emergency brake uncovering bolts attaching center console.



STEP 4. Remove (2) bolts holding down front center console. Which are located right next to emergency brake.

Note: Some model years may require the use of a T-15 torx instead of 7mm socket to remove screws.

TOOLS: Ratchet, Extension, T-15 Torx or 7mm Socket



STEP 5. Remove passenger side panel by pulling it down. C7: Remove **driver side** panel ONLY.

For C7 application, skip **step 6** and move on to **step 7**.



STEP 6. Lift leather boot out of center console trim plate.



STEP 7. Hold top of knob and turn chrome collar counter-clockwise to loosen collar and access bolt securing knob.
Note: Some model years may require the use of a small phillip screwdriver or T-20 (**C7: T-25**) torx socket to remove the knob from the shifter. DO NOT remove chrome collar from leather boot.

TOOLS: Ratchet, Extension,
T-20 Torx, T-25 Torx or
Small Phillip Screwdriver.



STEP 8. Remove center console trim plate from center console. Be sure to unclip any connectors that would prevent the removal of the center console trim plate.
For C7, remove bottom section only.

TOOLS: Trim Panel Removal Tool

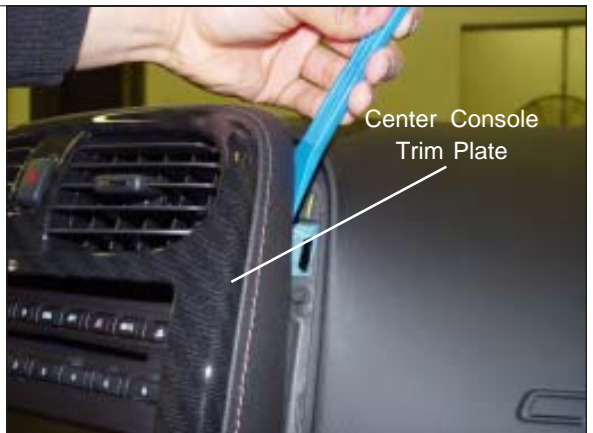

FOR C6 & C6(ZO6): SKIP STEPS 9 - 12
FOR C7: CONTINUE TO STEP 9

STEP 9. Carefully separate trim plate from lower console tray.

TOOLS: Trim Panel Removal Tool.



STEP 10. Remove back trim plate.



STEP 11. Remove nuts.

TOOLS: Ratchet, Extension,
& Socket (10mm)



STEP 12. Remove lower console tray.



STEP 13. Remove rubber cover around shifter.



STEP 14. Remove (4) nuts securing second rubber layer of shifter.

TOOLS: Ratchet, Extension & Socket (10mm)



STEP 15. With the E-brake in the ON position, place the shifter in neutral and remove 4 bolts securing shifter to transmission shifter base.

TOOL: Ratchet, Extension, & Socket (3/8")



STEP 16. Gently remove pivot cup from bottom of stick. For extra protection, use a towel between the channel locks.

TOOL: Channel Locks



ASSEMBLY

STEP 17. Grease B&M Shifter pivot ball and snap original pivot cup into shifter.



STEP 18. Remove old rubber gasket completely and install provided gasket.

TOOL: Flathead Screwdriver or Gasket Scraper



STEP 19. Install B&M shifter. Secure B&M shifter to transmission shifter base with provided (4) 1/4" washers and (4) 1/4"-20 screws.
*Add a drop of Loctite[®] 242 to threads for added security. Test shifter through all gears.

TOOLS: Ratchet, Extension, & Socket (7/16")



OPTIONAL INSTALLATION

NOTE: The following steps are to install the optional spacer and washer that is provided in the kit. A much more solid shifting feel is obtained if installing the provided spacer and washer because it replaces the much softer stock bushings. These steps are not necessary on Z06 model vehicles as it is already solid mounted.

IMPORTANT: The installation of the spacer and washer will transmit more noise and vibration than the softer rubber bushings. If a quieter and less vibration transmitting shift quality is preferred over a more solid and direct shift feel, then DO NOT proceed with these optional (A-F) installation steps.

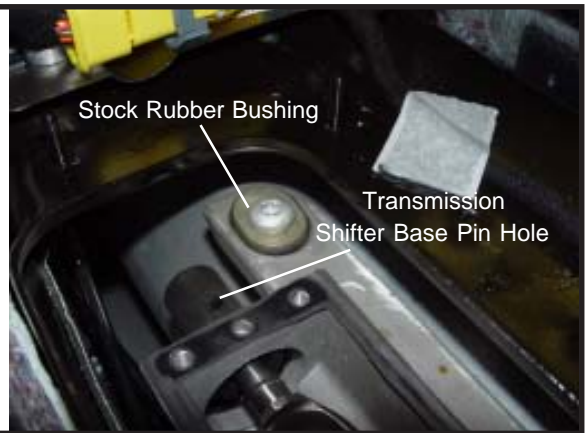

STEP A. See top-right picture for indication of working area. Remove "L" pin from the stock shifter. With the shifter still in neutral and E-brake in the ON position, insert the "L" pin into the pin hole of the shifter base. The "L" pin is used to keep everything aligned. If done correctly, shifter should not be able to shift out of neutral position.

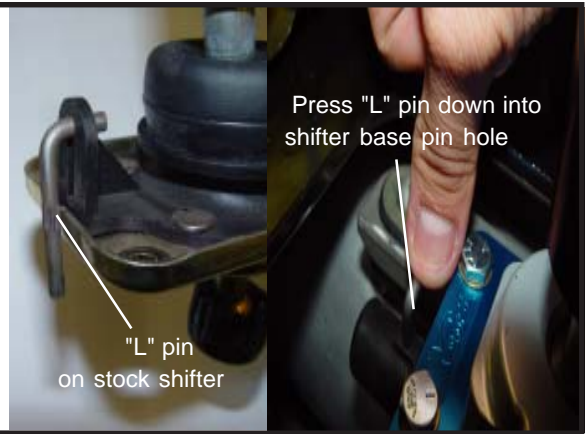

STEP B. Remove bolts (2) securing shifter base to vehicle.

TOOLS: Ratchet, Extension, T-40 Torx Socket



STEP C. Remove stock rubber bushings and spacer.

TOOL: Small Flatblade Screwdriver



STEP D. Install the provided spacers underneath base as shown.

CAUTION! Be careful not to allow spacers to fall under transmission shifter base because of the difficulty of retrieving spacer. Use necessary precautions.

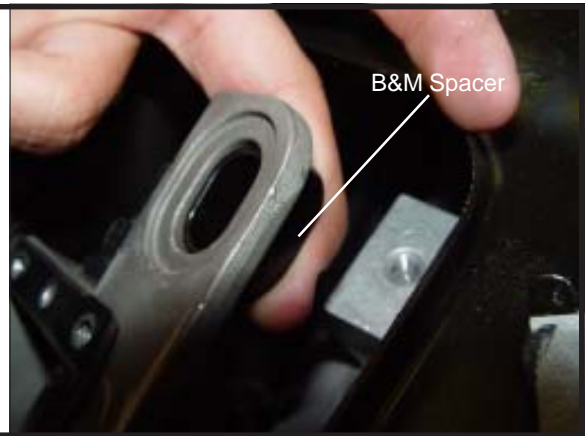

STEP E. Place (2) provided washers on top of each spacer and thread bolts securing shifter base to vehicle.

TOOLS: Ratchet, Extension, T-40 Torx Socket



STEP F. Remove "L" pin from pin hole and test shifter through each gear.



STEP 20. Reinstall second rubber layer, securing rubber using (4) nuts. Reinstall first rubber layer.

TOOLS: Ratchet, Extension, Socket (10mm)



STEP 21. Reinstall all connector wires to center console.
Install knob into leather boot before installing back into shifter (clip knob back into chrome collar).
Reinstall center console trim plate.
Install knob into shifter.



STEP 22. Reinstall leather boot into center console trim plate.
Unclip knob from chrome collar and screw provided bolt into shifter, make sure bolt presses firmly onto knob. Clip chrome collar back into knob.

C6: USE M6 BOLT & LOWER HOLE ON STICK.
C7: USE M5 BOLT & UPPER HOLE ON STICK.

TOOL: Allen Wrench (4mm for C6, 3mm for C7)



STEP 23. Reinstall passenger side panel by lifting it up until it snaps into place.



STEP 24. Reinstall (2) bolts holding down front center console. Which are located right next to emergency brake.

Note: Some model years may require the use of a T-15 torx instead of 7mm socket to remove screws.

TOOLS: Ratchet, Extension,
T-15 Torx or 7mm Socket



STEP 25. Reinstall sleeve around emergency brake.



STEP 26. Reinstall (2) screws on center console trim plate and covers.

Note: Some model years may require the use of a 7mm socket instead of T-15 orx to remove screws.

TOOLS: Ratchet, Extension, T-15 Torx or 7mm
Socket



STEP 27. Reinstall (4) bolts securing arm rest and remove arm rest.

TOOLS: Ratchet, Extension, T-15 Torx Socket



STEP 28. Ensure that all gears can be smoothly and fully engaged without binding or rough movement. Correct any problems prior to operating the vehicle.



STEP 29. Enjoy!

